

# Three-Position Push Pull Solenoid

## Description:

This example of a continuous duty “three-position” solenoid features a push-pull from a center position. The plunger extends into position with the application of power. When the power is removed the plunger returns to the center position. When power is applied to the additional lead, the plunger retracts to the third position and holds with the constant application of power. The plunger returns again to the center position when the power is removed. This design allows for a tighter tolerance and eliminates the need to setup and adjust two springs. Strokes and forces are flexible depending on solenoid size.



## Features:

- Push-pull from center position
- Lower power consumption
- Increased performance in smaller package
- High cycle life

## Possible Applications:

- Security devices
- Vending equipment
- Position controls
- Business machines
- Door locks
- Damper controls

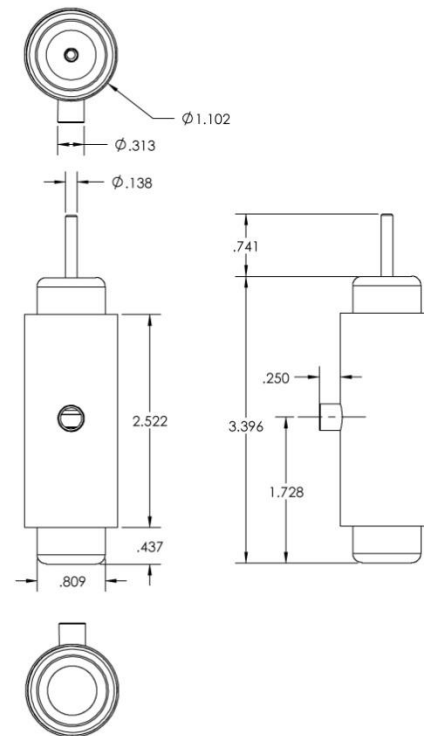

## Example Specifications:

## Metric (English as applies)

Stroke (either direction from center)	1.58 to 25.4 mm (.62 to 1.0 in)
Push-Pull Force (can be designed to specification)	.03 to 4.5 kgf (1 oz to 10 lbs)
Resistance at 20°C	Per voltage requirement
Supply Voltage	3 to 48 Vdc
Duty Rating (%ED)	100% ED
Operating Temperature Range	-40 to 120°C (-40 to 248°F)
Durability	>10M cycles