

Intrinsically Safe Latching Solenoid

Description:

This example of latching technology originally designed to protect “run-away” pumps features a high speed “extend” operation and is an excellent solution for applications involved in highly flammable or combustible environment. Design can be customized to fit a variety of safety applications.



Features:

- High speed extend and retract
- Built in protection circuitry
- Environmentally protected
- Can be designed to customer electronic drivers

Possible Applications:

- Flammable gas, vapor or liquid environments
- Combustible dust environments
- Ignitable fibers environments

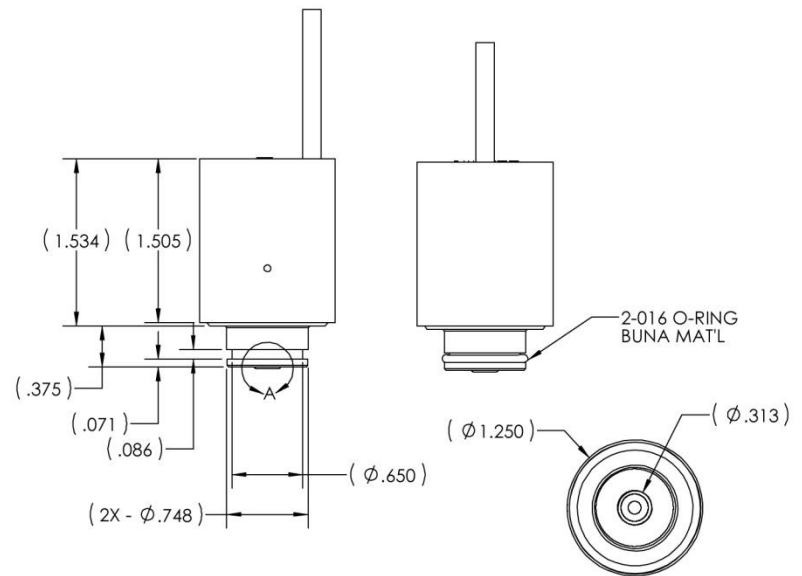

Example Specifications:

English (metric as applies)

Stroke (can be designed to specification)	.120 in (3.05 mm)
Supply Voltage	6, 12 or 24 Vdc
Response Time	17-26 ms
Operating Temperature Range	-40 to 140°F (-40 to 60°C)
Operating Voltage	6.8-7.8 Vdc
Coil Resistance at 20°C	13.0 \pm .5 Ω
Inductance @ 1 kHz	26 mH max
Net Spring Preload	.65 lb (2.9 N) min